



D'CAD[®]

INTERIOR DESIGNING INSTITUTE

Government Reg.

Since
2009

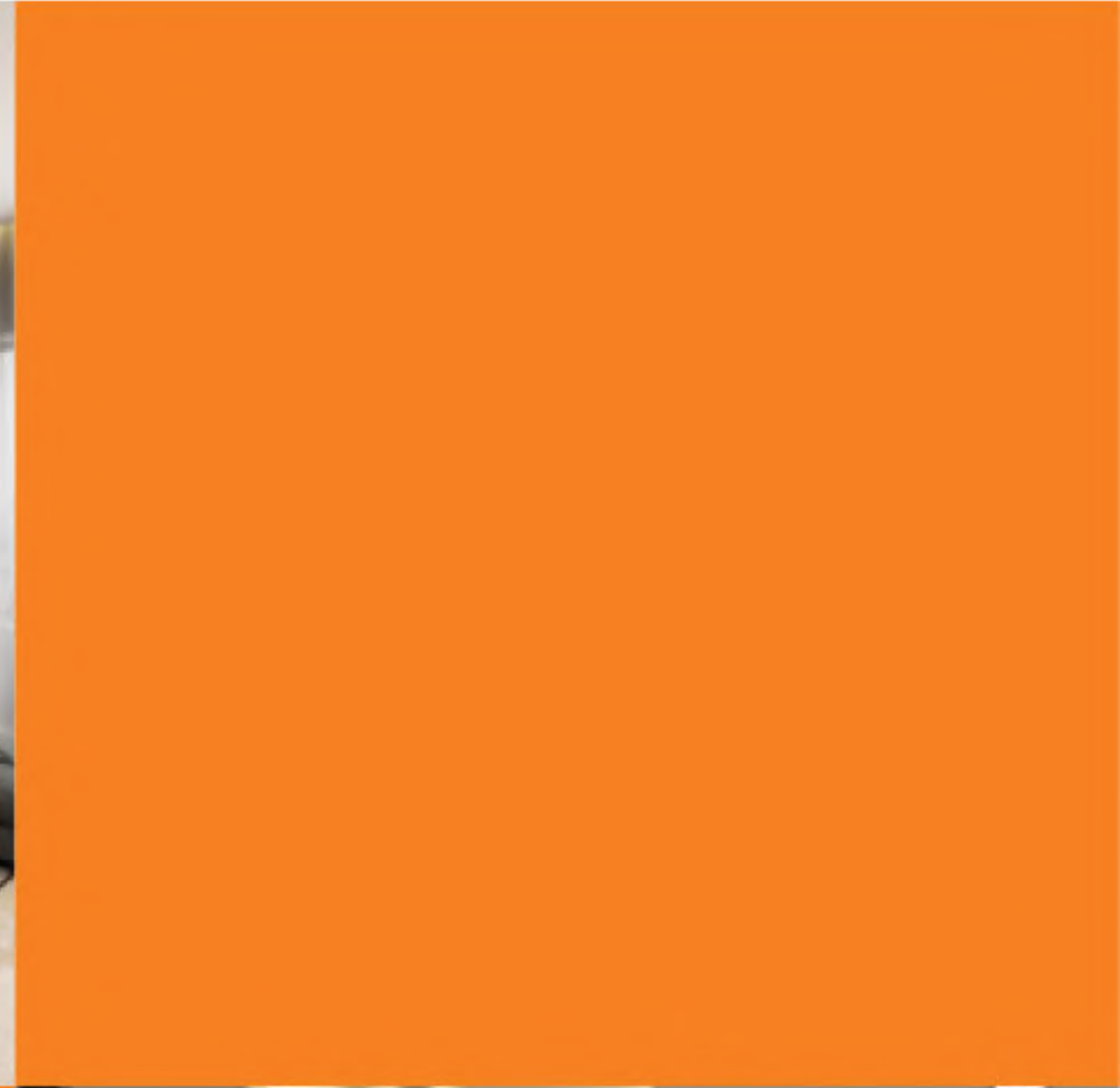

Auto CAD 2D (120 hrs)

CIVIL LAYOUT

Data Plan with measurement
Demolished data plan
Civil layout with plaster line including door frames, window frames + legend

BASIC DESIGN

Use of tints and tones
Shaded color mode & patterns
Ornamental design
Grills & gate designs
Conceptual design

CEILING LAYOUT

Leveling & use of materials
Cut sections
Legend of false ceiling

FURNITURE LAYOUT

Standard size of furniture's
Zoning of layout
Creating of space & planning
Furniture layout with material specification including zoning of

ELEVATION & SECTIONAL

Rare elevation
Front elevation with heights & material speciation

ELECTRICAL LAYOUT

Layout & light point
Switch board & heights
Electrical legend & symbols

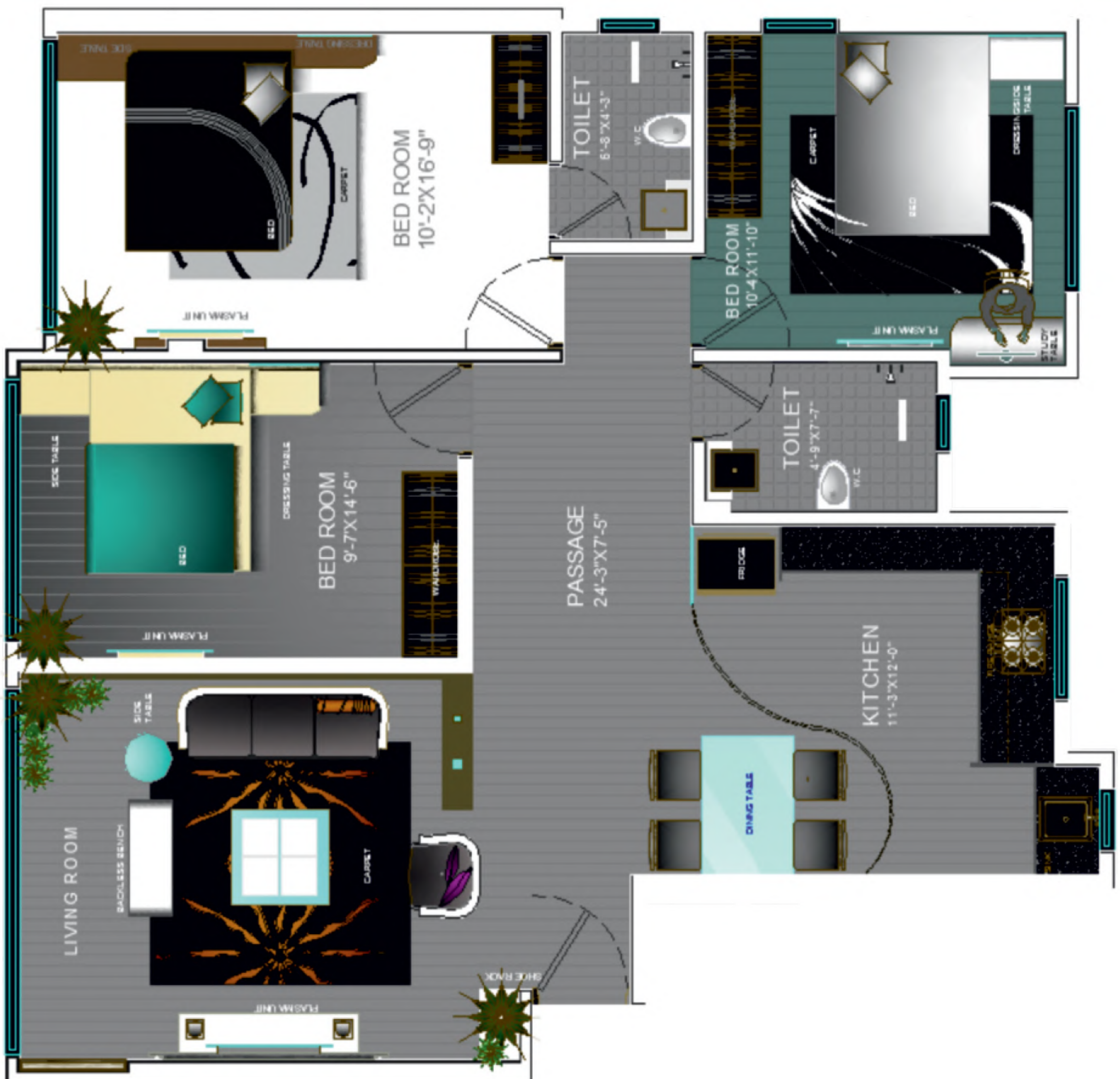



3Ds Max | Vray | Photoshop (360 Hrs)

MODELLING

Introduction
Basic functions of key & unit set up
Editable spline modeling
Modeling in editable poly
Using free form deformation bevel & bevel profile

LIGHTING

Theory of standard lights,
understanding types of lights
& shadows, sunlight

POST PRODUCTION

Image editing, adjustment of color range, clip & section options, layer & layer marks, color balance, channel, group & filters, paintbrush options, environment effects, landscaping view, final project rendering.

TEXTURING

Apply material & ID, texture editor, making shades, layered texture, making bump map, adjusting color, adjusting specular highlights, UVW mapping

RENDERING

Theory of mental ray, render, render setup, improvements of the environment effect, working with the landscape & elements of render.

Revit Architecture (60 hrs)

Building information modeling for architectural design, working with revit elements & families.

Creating & Modifying levels & grids, creating a basic floor plan.

Using editing & modification of tools

Working with dimensions

Applying & Removing constraints.

Applying creating modifying floors, roofs, stairs, railings, curtain, walls.

Working with ceilings, creating & modifying

Creating renderings, walkthroughs

Google Sketch Up (60 hrs)

Introduction to sketch up, creating of groups & components

Applying texture & materials, Colours

Creating of landscape, Turning 2D into 3D



DIPLOMA IN INTERIOR DESIGN

DESIGN

Design Elements, Schemes & themes, Existing Drawings
Civil, Furniture, Flooring, Electrical, Ceiling
Plumbing Layout & Views

DESIGN THEORY

Properties of designing , Letter writing, Material theory
Technological theory, Basic Vastu, Landscaping and
Interior oscares, Estimation

DRAWING AND PERSPECTIVE

Drafting line, Lettering, Scale, Orthographic Projection
Isometric Views, Critical Object, Ortho Of Furniture
One Point Perspective, Two Point Perspective

WORKING DRAWING

Different Brick Forms, Brick bond, Joineries,
wooden, stone, frame & its details, wooden door-window
frame & its details, t.v unit with paneling

Bed with head board & side table, Wardrobe & dressing table, Kitchen

PHOTOGRAPHY COURSE

History of photography and types of cameras

Major controls on camera, Shutter, aperture, lenses, Exposure, ISO

Knowing the right lenses and Exposure Modes

Depth of field, using it effectively and knowing factors affecting depth

The art of Composition

Different photography techniques like panning, zooming, shooting .

Portrait photography and shooting Landscapes

Filters in digital photography

Macro photography

Understanding Light

Getting true to life colors in your pictures.

VASTU SHASTRA

Introduction, Understanding vastu ,

Implementing in rooms , Implementing in study area,

Implementing in kitchen

Implementing in overall interior

Vastu Compass, Vastu colours, Diagonal vastu

Types of feng-shui, Defects of vastu, effects of vastu

